

# GEONEX GR 50

## GEONEX DTH-DRILLING ROTARY HEADS



Geonex Rotary Heads are engineered for DTH-Drilling. Design is compact and strong engineered for both horizontal and vertical drilling. Rotary head can be mounted straight to feed carriage or as an option, there is also possibility for tilt function with cuttings collector. Speed switching valve option and different motor sizes also enables drilling of large diameter range. Rotary head has in-built air swivel with large hole through.

### APPLICATIONS FOR GEONEX GR 50

✓ **HZR610 horizontal drilling rig**

The GR 50 rotary head is compatible with the HZR610 horizontal drilling rig.

✓ **Vertical drilling and micro piling rigs**

The rotary head is engineered for both horizontal and vertical drilling applications.

✓ **Anchoring and special drilling rigs**

The GR50 can be attached to a variety of special drilling rigs from different brands.

### TECHNICAL INFORMATION

Geonex GR 50	
Weight kg (lb)	650(1433)
Length (with out threads adapter) mm (ft in)	520 (1' 8,5")
Width mm (ft in)	580 (1' 11")
Height mm (ft in)	615 (2' 7/32")
Thread connection (can be specified according to customer needs)	Api Reg 3 1/2" F, Api Reg 4 1/2" F, Api Reg 6 5/8" F, Hex heads
Max oil flow lpm (gpm)	300 (119)



**GEONEX OY**

Tel. +358 400 693 143

info@geonex.fi

Teollisuustie 9, FI-95600 Ylitornio, Finland

FOR MORE INFORMATION VISIT

[www.geonex.fi](http://www.geonex.fi)



# GEONEX GR 50

GEONEX DTH-DRILLING ROTARY HEADS

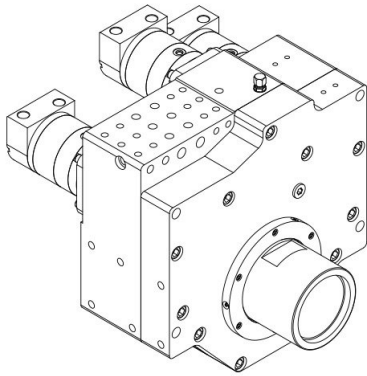
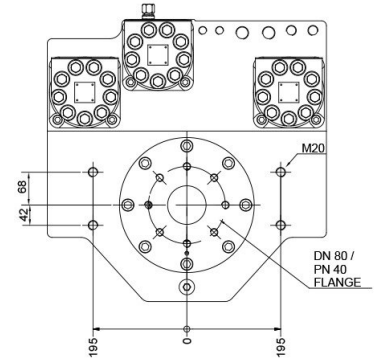
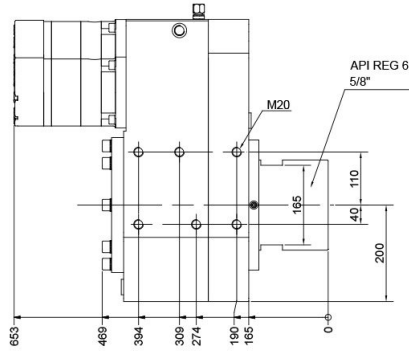
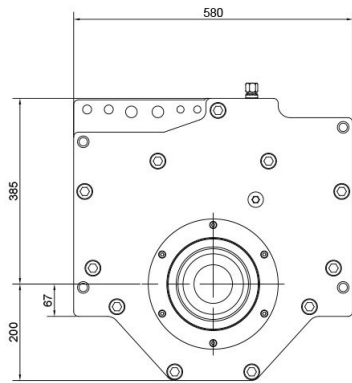

GEONEX GR50 ROTARY HEAD